

Camping *** Le Port de Limeuil 24480 Alles-sur-Dordogne

LOCATION DU GÎTE-APPARTEMENT BOOKING CONTRACT

The gîte is a flat with a mezzanine and a terrace. Maximum 8 people.
The main room contains a kitchen with fridge, dish washer, micro-wave, plates and dishes, a table and 4 chairs, sofa convertible in 2 beds (190x80), TV.VIDEO and CD/radio. On the same floor, 1 bedroom with 1.6x2m bed, a bathroom with sink , shower and separate bath, toilets.

Terrace : 1 table, 8 chairs, 1 barbecue and 2 sunbeds.

Upstairs, 1 small bedroom with a 1.40x1.90 bed. On the open mezzanine, 2 folding beds 80x190.



We would like to book the gîte-flat :

NAME : First name :

Street :

City.....PostCode.....Country.....

Telephone : Fax : E-mail :

Number of people : Special requests :

From Saturday After 4 p.m.

To Saturday Before 10 a.m.

RATES/ GÎTE-FLAT 2011 (per week)

April, May, from 1st to 11th June, Sept. : 1 to 3 pers 290 €

4 to 8 pers. 390 €

From 11th to 25th June : 1 to 3 pers .490 €

4 to 8 pers. 590 €

From 25th June to 2nd July 650 €

From 2nd to 9th July 650 €

From 9th to 16th July 950 €

From 16th to 23rd July 950 €

From 23rd to 30th July 950 €

From 30th July to 6th August 950 €

From 6th to 13th August 950 €

From 13th to 20th August 950 €

From 20th to 27th August 650 €

The price includes :
The amount of people, electricity, gas and water.
If there are more people, you will have to pay at the normal rate.
You will have to pay the local taxes: 0.38 per night and per person from the age of 13.

The total amount is :€

To take your booking we need : 25% of total amount + 15 € for booking charges.

Debit card or Credit Card (16 digits).....Expire date...../.....

(We do not accept American Express or Gold Card.)

Booking fee: 15€ Deposit :€

HOW TO BOOK

The booking form must be sent back with the deposit, and the booking fee within 15 days. We will send you a confirmation by post.

Your accommodation will be available from 4pm. You have to leave before 10am on the last day.

You must clean the accommodation before leaving, otherwise we will charge you 50€.

When you arrive we need your credit card details in case of damage.

You are obliged to pay the total amount of your stay the day you arrive.

CANCELLATION

Until 2 months before arrival, the deposit will be refunded.

Between 2 months and 2 weeks before arrival, your deposit will not be refunded.

Less than 2 weeks before arrival, the total amount invoiced must be paid.

INSURANCE TERMS

We advise you to take an insurance that will pay you back in case of cancellation for a serious reason.

French law shall govern the agreement and the court of law of Bergerac shall have sole jurisdiction.

Date and Signature

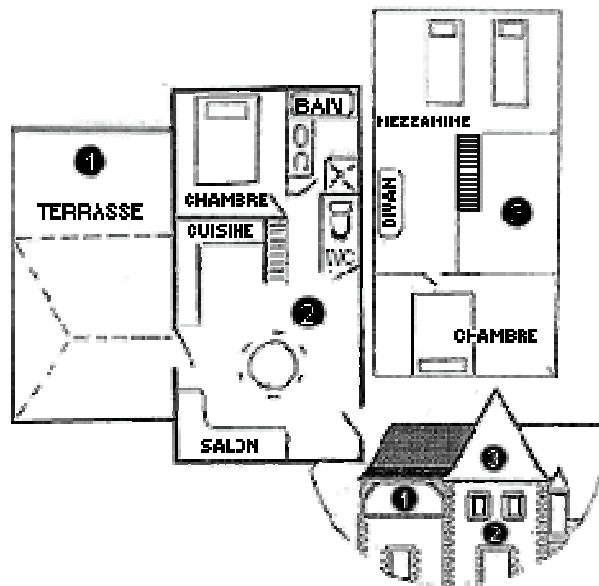

Tél.00.33.5.53.63.29.76 Fax 00.33.5.53.63.04.19 MOBILE 06.81.95.16.12

didierbonvallet@aol.com www.leportdelimeuil.com

SARL NADI – RC B 411 831 357 – 97 B 75